

Soils Map

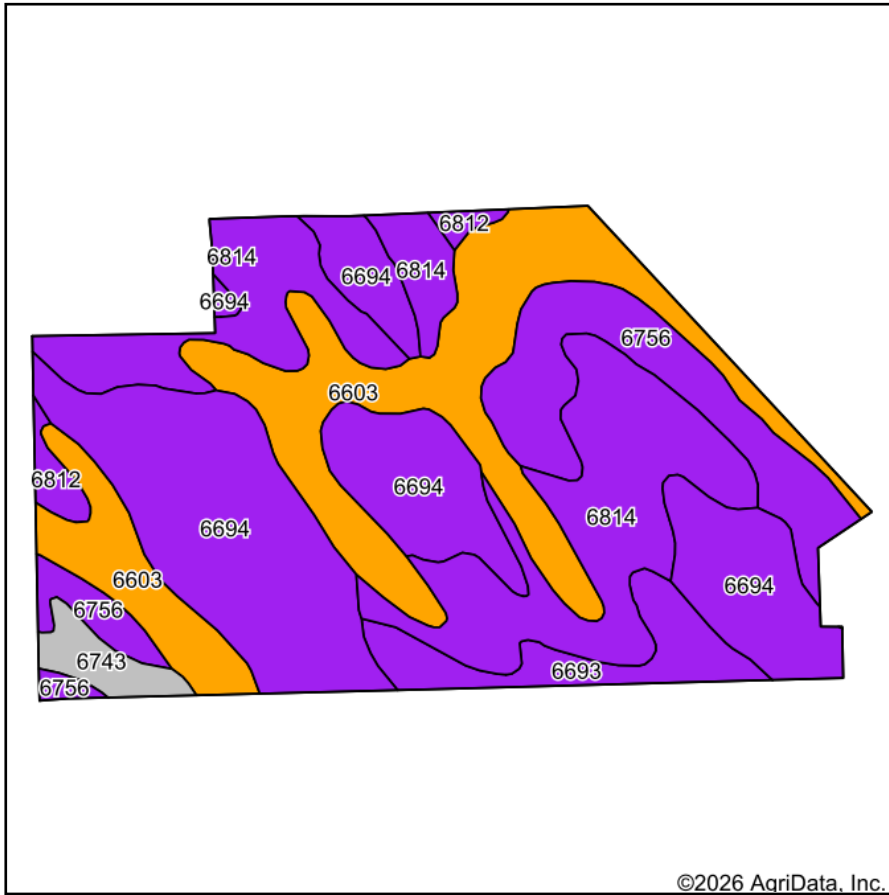

Soils data provided by USDA and NRCS.

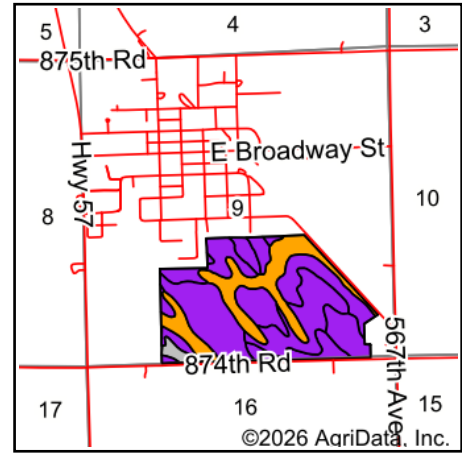

State: **Nebraska**
 County: **Cedar**
 Location: **9-29N-2E**
 Township: **Precinct 16**
 Acres: **149.04**
 Date: **2/1/2026**



Maps Provided By:



Area Symbol: NE027, Soil Area Version: 25

Code	Soil Description	Acres	Percent of field	NCCPI Overall Legend	Non-Irr Class *c	Irr Class *c	SRPG	*n NCCPI Overall	*n NCCPI Corn	*n NCCPI Soybeans
6694	Crofton-Nora complex, 6 to 11 percent slopes, eroded	47.38	31.8%		IVe	IVe	57	64	60	64
6814	Moody silty clay loam, 6 to 11 percent slopes, eroded	36.29	24.3%		IIIe	IVe	67	63	62	61
6603	Alcester silty clay loam, 2 to 6 percent slopes	35.18	23.6%		Ile	IIIe		75	74	73
6756	Nora silt loam, 6 to 11 percent slopes, eroded	17.39	11.7%		IIIe	IVe	64	67	61	66
6693	Crofton-Nora complex, 2 to 6 percent slopes, eroded	7.64	5.1%		IIIe	IIIe	61	67	62	67
6743	Thurman-Ortello complex, 6 to 11 percent slopes	3.06	2.1%		VIe	IVe	47	42	40	34
6812	Moody silty clay loam, 2 to 6 percent slopes, eroded	2.10	1.4%		Ile	IIIe	71	64	64	64
Weighted Average					3.13	3.70	47	*n 66.4	*n 63.7	*n 65.2

*n: The aggregation method is "Weighted Average using all components"

*c: Using Capabilities Class Dominant Condition Aggregation Method