

Soils Map

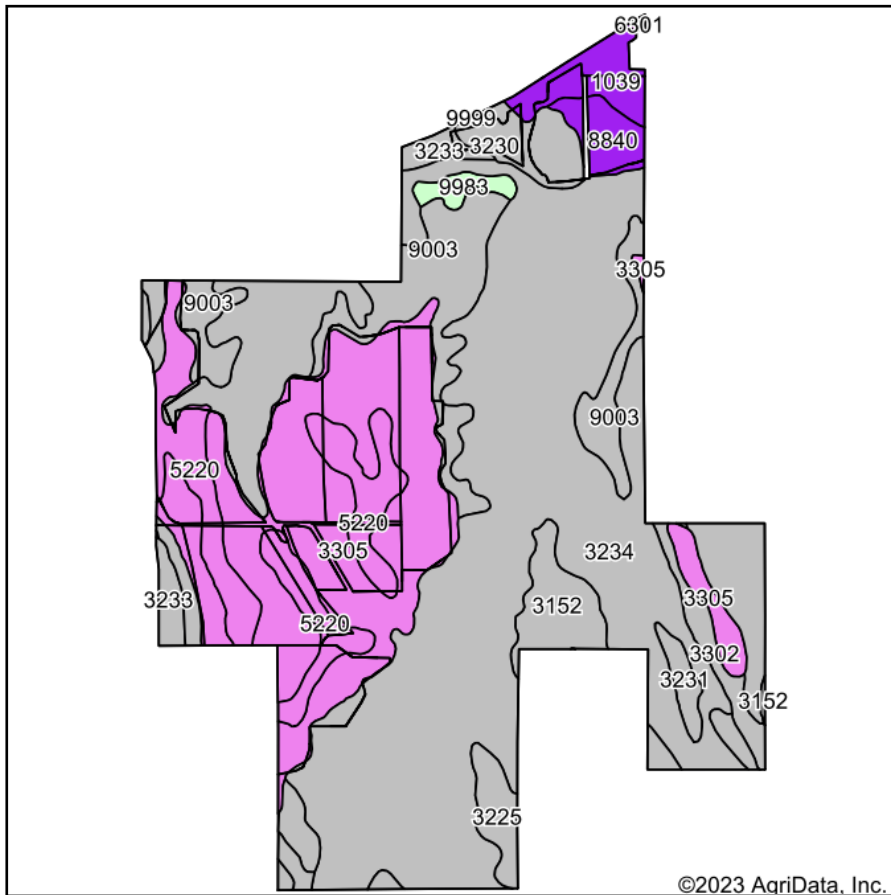

Soils data provided by USDA and NRCS.

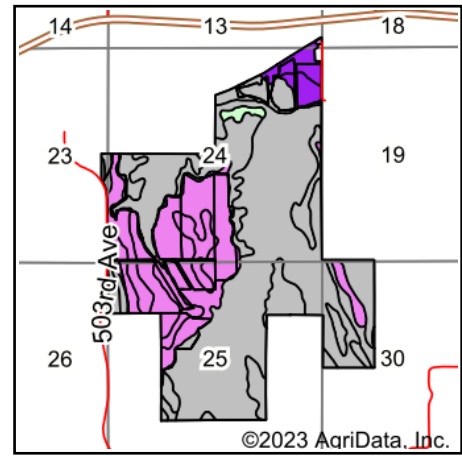

State: **Nebraska**
 County: **Boyd**
 Location: **24-33N-10W**
 Township: **Lynch**
 Acres: **837.77**
 Date: **12/20/2023**

MOSSY OAK
PROPERTIES
 Homestead Land & Management Co., Inc.
 America's Land Specialist

Maps Provided By:

 CUSTOMIZED ONLINE MAPPING
 © AgriData, Inc. 2023 www.AgriDataInc.com



Area Symbol: NE015, Soil Area Version: 25

Code	Soil Description	Acres	Percent of field	NCCPI Overall Legend	Non-Irr Class *c	Irr Class *c	SRPG	*n NCCPI Overall	*n NCCPI Corn	*n NCCPI Soybeans
3234	Monowi-Bristow silty clays, 11 to 30 percent slopes	408.99	48.8%			Vle	3	20	13	16
3305	Reliance silt loam, 2 to 6 percent slopes	162.16	19.4%			IIle	60	52	38	51
9003	Anselmo fine sandy loam, 9 to 15 percent slopes	84.66	10.1%			Vle	41	38	32	33
5220	Onita silt loam, 0 to 2 percent slopes	61.25	7.3%			IIc	65	57	47	56
3152	Boyd silty clay, 6 to 11 percent slopes	19.91	2.4%			IVe	20	36	19	28
3225	Labu-Sansarc silty clays, 9 to 35 percent slopes	19.88	2.4%			Vle	9	27	15	22
3230	Monowi silty clay, 2 to 6 percent slopes	18.10	2.2%			IIle	11	36	20	28
1039	Grigston silt loam, occasionally flooded	16.72	2.0%			IIw	56	67	45	67
8840	Hall silt loam, 0 to 1 percent slopes	11.66	1.4%			IIc	71	69	50	69
3302	Ree silt loam, 6 to 11 percent slopes	10.99	1.3%			IVe	56	49	37	48
3233	Monowi-Bristow silty clays, 6 to 11 percent slopes	10.98	1.3%			IVe	9	31	17	24
3231	Monowi silty clay, 6 to 11 percent slopes	6.08	0.7%			IVe	10	35	20	28
9983	Gravel pit	5.85	0.7%			VIIIIs	0			
6301	Aowa silt loam, channeled, 0 to 3 percent slopes, frequently flooded	0.43	0.1%			VIw	44	52	44	52
9999	Water	0.11	0.0%				0			
Weighted Average								*n 33.7	*n 24.1	*n 30.4

*n: The aggregation method is "Weighted Average using all components"

*c: Using Capabilities Class Dominant Condition Aggregation Method

*- Non Irr Class weighted average cannot be calculated on the current soils data due to missing data.

*- Irr Class weighted average cannot be calculated on the current soils data due to missing data.

Soils data provided by USDA and NRCS.